

Fair Warning Fair Warning Fair Warning Fair Warning Fair Warning Fair Warning RADAR DETECTOR

Owner's Manual and Mounting Instructions

Vetter

Introduction

Table of Contents

Introduction	2
Part Identification	3
Installation	4
Final Adjustments	6
Detector Removal	6
Detector Tips	7
Troubleshooting	10
Maintenance	10
Customer Service	10
Limited Warranty	11

NOTE Some states prohibit the use and/or possession of the radar detection units. Check local laws before installation or traveling.

This manual contains important information regarding the proper installation, safe operation and maintenance of your Fair Warning radar detector. We urge you to read this manual completely, understand all components of your detector.

In this manual statements preceded by the following words are of special significance:

WARNING MEANS THAT THERE IS THE POSSIBILITY OF PERSONAL INJURY TO YOURSELF AND OTHERS.

CAUTION MEANS THAT THERE IS THE POSSIBILITY OF DAMAGE TO THE RADAR DETECTOR AND RELATED COMPONENTS.

NOTE indicates points of particular interest for more efficient and convenient installation and operation.

First, we recommend that as you unpack your radar detector, use page 3 and 4 to study and recognize the various components.

Part Identification

1. RADAR DETECTOR
2. SWITCH & LIGHT PLATE
3. HORN
4. HARD TONNEAU COVER FOR RADAR
5. HORN BRACKET
6. GASKET
7. LOCK ASS'Y
8. KEY
9. CABLE CLAMP
10. IN-SPLICE
11. TWO-IN-ONE SPADE CONNECTOR
12. THUMB SCREW
13. AZTEC WASHER
14. MOTORCYCLE CABLE
15. CAR CABLE
16. HORN ATTENUATOR CAP

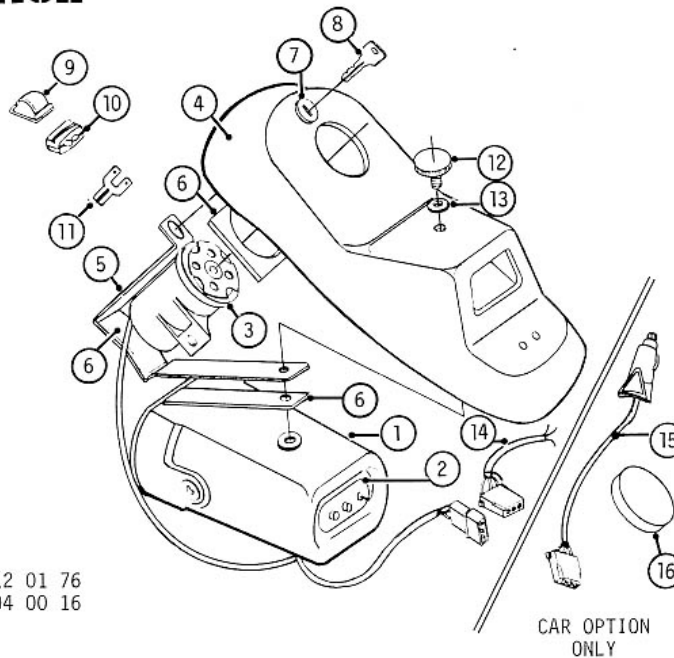

Replacement Parts

TONNEAU COVER	11	012	01	76
RADAR DETECTOR.	13	004	00	16

CAR OPTION
ONLY

3

Installation

The Fair Warning detector is totally automatic and has no range/gain control. It has only four functions which you must be familiar with. (illus. a)

1. Pilot Lamp (green)
2. Alarm Lamp (red)
3. Control Switch (left-city; right-highway; center-off)

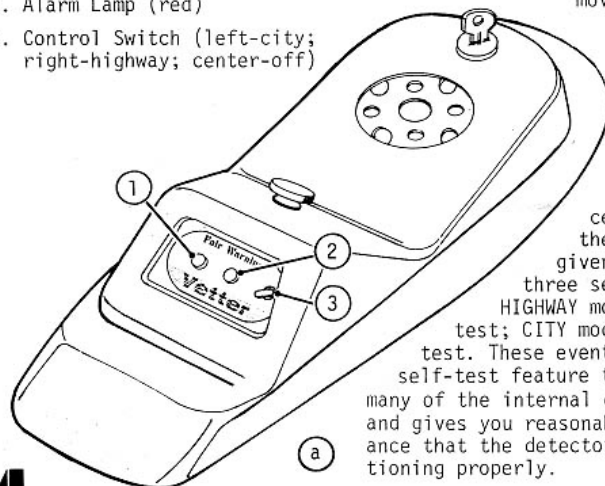

The control switch moved to the CITY mode causes the ALARM lamp to go on for about one second. After the alarm passes only the PILOT lamp will remain glowing. The same events occur when the detector is placed into the

HIGHWAY mode by moving the switch to the

extreme right except that the alarm is given for about three seconds.

HIGHWAY mode: Long test; CITY mode: Short test. These events are a self-test feature that tests many of the internal circuits, and gives you reasonable assurance that the detector is functioning properly.

NOTE All fairings are supplied with the necessary wires (Windjammer III, SS, IV, Vindicator, II and Kawasaki by Vetter fairings).

1. Located in the left pocket you will find the cigarette lighter hook-up. Remove the fuse from the fuse holder to prevent a possible short during the power hook-up.
2. Disconnect the short red power wire from the cigarette lighter (if lighter is installed).
3. Install the provided in-line splice as illustrated (mid-way between spade and fuse cap). Snap the connector closed with pliers making sure the insulation on the two wires have been cut through. (illus. b)

4

4. Reconnect the short section to the cigarette lighter (if the lighter is installed).

5. Hook up the fairing's black ground wire at the side of the cigarette lighter using the provided two-in-one spade connector. (If no cigarette lighter is used simply connect the terminals together using the two-in-one connector and cover with tape.) (Illus. c)

6. Route the power cable from the left pocket to the right through the front of the fairing.

7. Replace the fuse and hook up the fuse cap to the fuse holder.

8. Plug detector into the power cable.

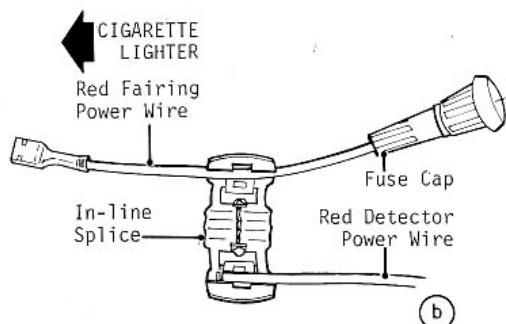

Fuse Holder

Fuse
(15 AMP)

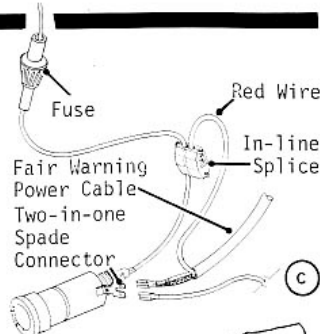

NOTE If your fairing has Leading Edge Light turnsignals, clean the inside of the right pocket near the front, close to the turnsignal wires. Peel the adhesive backing paper off the provided cord clip and mount the clip (open end up) in the cleaned pocket area. Push the wires in the clip, up away from the radar antenna's range.

5

Final Adjustments " - - - - - Removal " - - -

1. Check radar detector unit/tonneau cover for proper fit.

● Slide the hard tonneau cover down into place (cover clip will snap down snug into fairing).

● When locking the cover, there should be moderate key movement resistance. Too much or too little resistance indicates a need for lock cam adjustment. (Illus. d)

WARNING DO NOT OPEN TONNEAU COVER WHILE RIDING.

2. Check the thumb screw on the top of the tonneau pocket for tightness (don't over tighten). Periodically check for tightness.

NOTE Use only powdered graphite in the lock itself for lubricant.

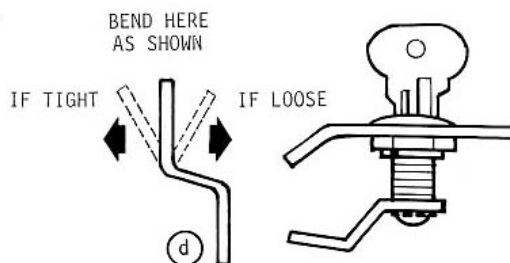

6

The Fair Warning detector is removable from the tonneau cover and can be used in your auto also. Please use the following instructions for removal.

1. Remove the hard tonneau cover from the fairing. Unplug detector power cable.

2. Remove the black thumbscrew from the tonneau cover.

3. Push the detector unit out of the tonneau cover (it is held securely by a foam gasket).

4. Lift the bracket and remove the horn.

5. Use the provided horn attenuator cap on the horn to reduce its volume in your auto.

NOTE The detector should function the same as when used in your fairing.

Detector Tips

6. Mount the detector in your auto by setting it on the dash or using the provided threaded inserts ($\frac{1}{4}$ "x20 Molly nuts) on the sides of the can. Bolts need not extend more than $\frac{1}{2}$ " into the can.

7. The detector needs a clear unobstructed view (metal disrupts antenna reception). Use the provided automobile power cable and plug the detector into the cigarette lighter.

8. When remounting the detector into the tonneau cover:

- Lift the bracket and replace horn, pressing it firmly into the foam gasket.
- Route the short cable under the bracket (away from the front of the antenna).
- Firmly press the detector into the foam gasket and carefully thread the black thumb-screw into the can. Tighten, but do not overtighten.

A motorcycle with an angular fairing, like a Windjammer is actually less visible to radar than a motorcycle without a fairing. Thus the motorcycle with the fairing must be closer to the same radar trap before its speed may be read than a motorcycle without a fairing. (Illus. e)

NOTE With the new police pulsed radar, detection can possibly be avoided. Decrease your speed rapidly at the first warning at approximately 3 (or more) miles per hour per second to a legal speed limit. Always be aware of all traffic around you.

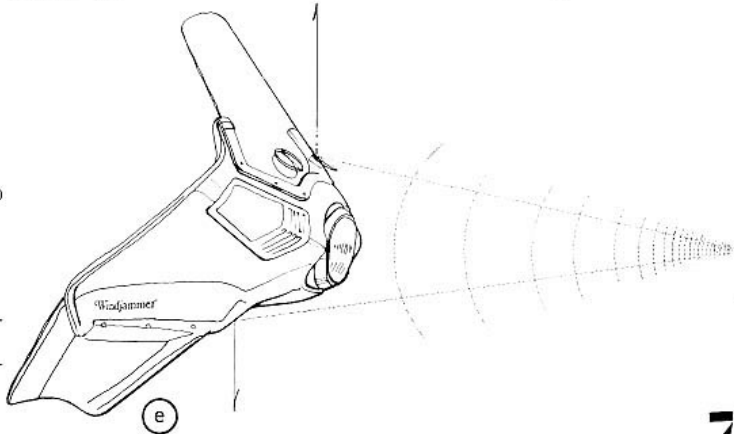

7

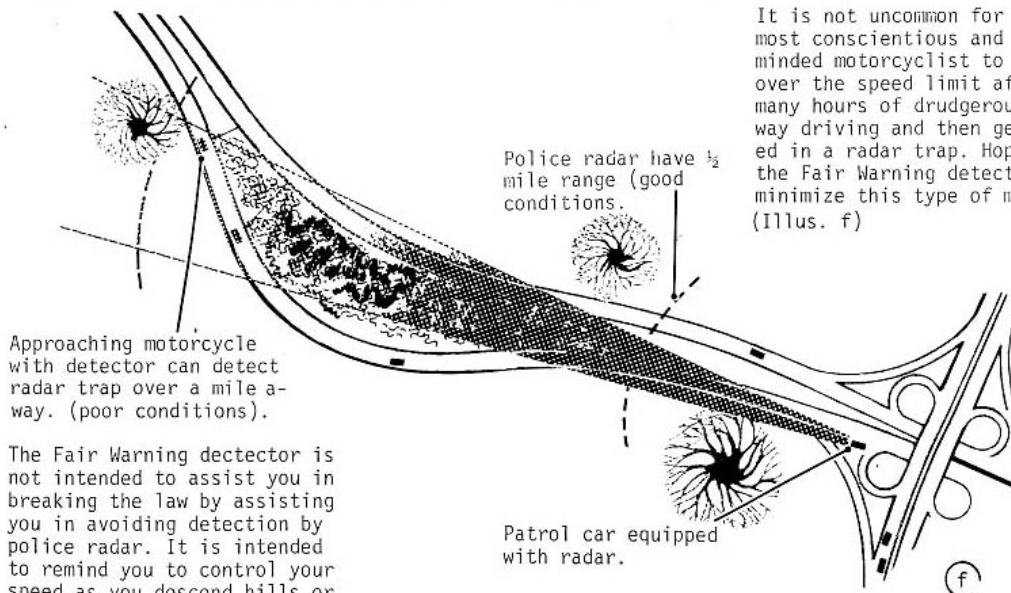

Approaching motorcycle with detector can detect radar trap over a mile away. (poor conditions).

The Fair Warning detector is not intended to assist you in breaking the law by assisting you in avoiding detection by police radar. It is intended to remind you to control your speed as you descend hills or approach curves where the police often set up radar traps.

Police radar have $\frac{1}{2}$ mile range (good conditions).

Patrol car equipped with radar.

It is not uncommon for the most conscientious and safety minded motorcyclist to slip over the speed limit after many hours of drudgerous freeway driving and then get nailed in a radar trap. Hopefully the Fair Warning detector will minimize this type of mishap. (Illus. f)

8

The radar transmitting antenna spreads out in a cone shape of about 30°. This means that the radar receiver is getting echos from all traffic within 30°. Thus, the target which has the greatest reflectivity and the largest optical size at a given range will have it's speed recorded as it returned the strongest echo. Thus, radar does not necessarily record the speed of the closest target. (Illus. g)

Radar energy is like light and travels in a straight line. Many people are under the illusion that radar traps cannot be detected before cresting a hill or rounding a curve. As indicated by illustration h, this is found to be false. The explanation for this is Scatter. Scatter is the process where the microwave energy, like light, hits particles of dust in the air and is bounced back (scattered) in all directions at greatly reduced energy levels.

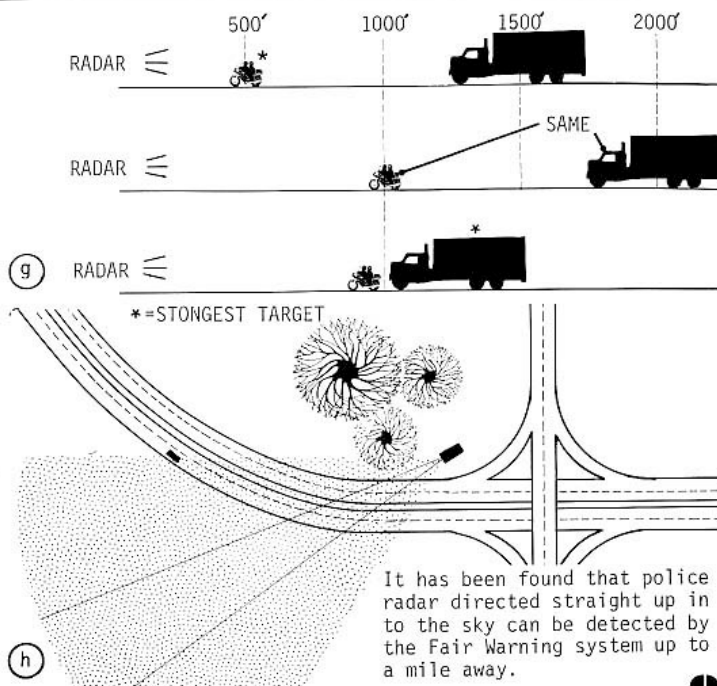

Troubleshooting and Maintenance

If your problem is electrical, check your color code to insure the proper wires have been connected. If no power is getting to the detector (green light should light), check to see that the wiring harness is making a good connection. If still no power is getting to the detector, check the motorcycle's owner's manual for determining the cause of possible fuse failure before replacing the fuse. The next step is to check the in-line splice for a good contact. This is done by reversing the steps to connect it. Check the wire to make sure the tab has cut through the insulation to the wire itself. Resnap the connector. A loose spade connector can be improved by unplugging the connector and making the female smaller by the use of pliers then reconnecting it.

CAUTION

THE FAIR WARNING DETECTOR IS WEATHER RESISTANT, BUT WE ADVISE YOU TO REMOVE THE DETECTOR AND REPLACE THE ORIGINAL TONNEAU COVER WHILE WASHING YOUR FAIRING.

The Fair Warning detector installed in the presence of a microwave security system, next to a radar system at an airport or near a telephone company transmitter will cause the detector to sound an alarm. The motorcycle will have to be moved out of the vicinity of this microwave energy, and then it will operate normally.

These areas are "Hot Spots". You should become familiar with them in your town and surrounding country where they could set the detector off to sound

an alarm at the same location every day. Switching to the CITY mode will minimize false alarms by reducing sensitivity.

NOTE

Any obstruction in front of the Fair Warning detector will reduce its range. Metal or metallic substances will block radar wave detection. DO NOT store tools or silver objects (with metallic pigments) in front of Fair Warning detector.

Customer Service

If there are any problems that cannot be solved by yourself, contact your dealer. If your dealer is unavailable, contact the Customer Service Department, Rantoul, IL 61866 (217) 893-3900.

Limited Warranty

This Warranty applies to products manufactured or distributed by Vetter Corporation, Rantoul, IL 61866, and sold by Vetter Corporation and its authorized dealers within the United States, Puerto Rico, and the Virgin Islands. It is given to the first retail purchaser only and is not transferable to subsequent owners.

WARRANTY OBLIGATION: Vetter Corporation warrants that it, or one of its authorized dealers, will repair or, at its option, replace any part proven to be defective in factory material or workmanship within six (6) months (unlimited mileage) of the date of purchase. Parts repaired or replaced under this warranty are warranted only during the balance of the original warranty period. **THIS WARRANTY DOES NOT INCLUDE ANY LABOR CHARGES FOR TROUBLESHOOTING, REMOVAL OR INSTALLATION.**

EXCLUSIONS FROM COVERAGE: 1. Any repairs or replacements of parts necessitated by misuse, negligence, fire accident, damage caused by exposure to gasoline, brake fluid, harmful solvents and cleaners, paints, or repair material, use of unauthorized accessories, faulty installation, installation upon motorcycles or vehicles not listed in Vetter Corporation's retail and dealer catalog sheets, or improper or unreasonable

maintenance are not covered. 2. This Warranty does not cover "Totes" rain-boots.

DISCLAIMER OF CONSEQUENTIAL DAMAGES AND LIMITATIONS OF IMPLIED WARRANTIES: TO THE EXTENT THE LAW PERMITS, VETTER CORPORATION SHALL NOT BE LIABLE UNDER ANY CIRCUMSTANCES FOR LOSS OF USE OF THE PRODUCT, CONSEQUENTIAL OR INCIDENTAL DAMAGES. ANY IMPLIED WARRANTY ARISING UNDER LAW, INCLUDING THOSE OF MERCHANTABILITY AND FITNESS FOR A PARTICULAR PURPOSE IS LIMITED TO THE DURATION OF THIS WARRANTY.

IMPORTANT: Some states do not allow limitations on how long an implied warranty lasts and/or limitations or exclusions of consequential or incidental damages, so the above limitations may not apply to you.

To Obtain Warranty Service: Information you must provide when filing claim: 1. Name, mailing address and telephone number. 2. Selling dealer's name and address. 3. Serial number on serialized products. 4. Model and year of motorcycle. 5. Date product was purchased. 6. Date and mileage at failure. 7. Description of the problem.

Steps to Take: 1. Contact or take your product to an authorized Vetter dealer (preferably your selling dealer) at your expense. 2. If you are unable to obtain warranty service, or should your warranty claim be denied for reasons that you consider unjustifiable, contact your dealership owner. Normally, this should resolve your problem, however, if you require further assistance, write or call the Customer Service Department of Vetter Corporation, Rantoul, IL 61866, (217) 893-9300. At this point, you must be prepared to return the part in question to Vetter Corporation with all freight charges prepaid. The charges will be reimbursed to you if they total over \$5.00 (five dollars) and the warranty claim is honored. This warranty gives you specific legal rights and you may also have other rights which vary from state to state.

September 30, 1979

Vetter Corporation

11

WARNING

PROTECT YOURSELF

INSTALLATION — Improper installation can cause an accident. See your Owner's Manual and Mounting Instructions.

MODIFICATIONS to the fairing or mounting hardware may render your motorcycle unsafe.

PROTECTION — This fairing is designed to help protect you from the elements. It is not intended to protect you in an accident.

WINDSHIELD — All windshields can break, which may result in injury. Replace a cracked windshield before riding the motorcycle.

CAUTION

PROTECT YOUR INVESTMENT

FASTENERS — Inspect and tighten all bolts and clamps frequently. Replace any missing parts.

BRAKE FLUIDS — Never allow brake fluid to contact the fairing or windshield.

WINDSHIELD CLEANING — Use mild soap and water with a soft cloth. Don't use coarse cloth, abrasive cleaners, ethyl or methyl alcohol, gasoline, or solvents.

REPAIR & PAINTING — See your Owner's Manual for detailed instructions.

If you have further questions, see your Owner's Manual, then contact your dealer. If he is not available, contact our Customer Service Department, Vetter Corporation, Rantoul, IL 61866 (217) 893-9300.

NOTE

Since your tonneau cover was removed with the fairing's maintenance decal we have re-printed it here for your reference.

14 013 00 93 ©Vetter Corporation 1-18-80